

# MODEL 2505 3-WAY SOLENOID VALVE

## SPECIFICATION

VALVE HOUSING.....	GLASS FILLED NYLON
INLET.....	3/4" NPT
OUTLETS.....	1/2" NPT
WETTED METAL PARTS.....	430 STAINLESS STEEL
SEAL AND "O" RING.....	VITON
COIL.....	EPOXY ENCAPSULATED
TERMINALS.....	WEATHER PACK, SHROUD HALF
VOLTAGE.....	12 VOLTS
CURRENT.....	1.7 AMPS at 12 VOLTS
OPERATING PRESSURE.....	80 PSI MAXIMUM
FLOW.....	0-2GPM (.9 CV)
TEMPERATURE.....	150°F MAXIMUM

## MOUNTING

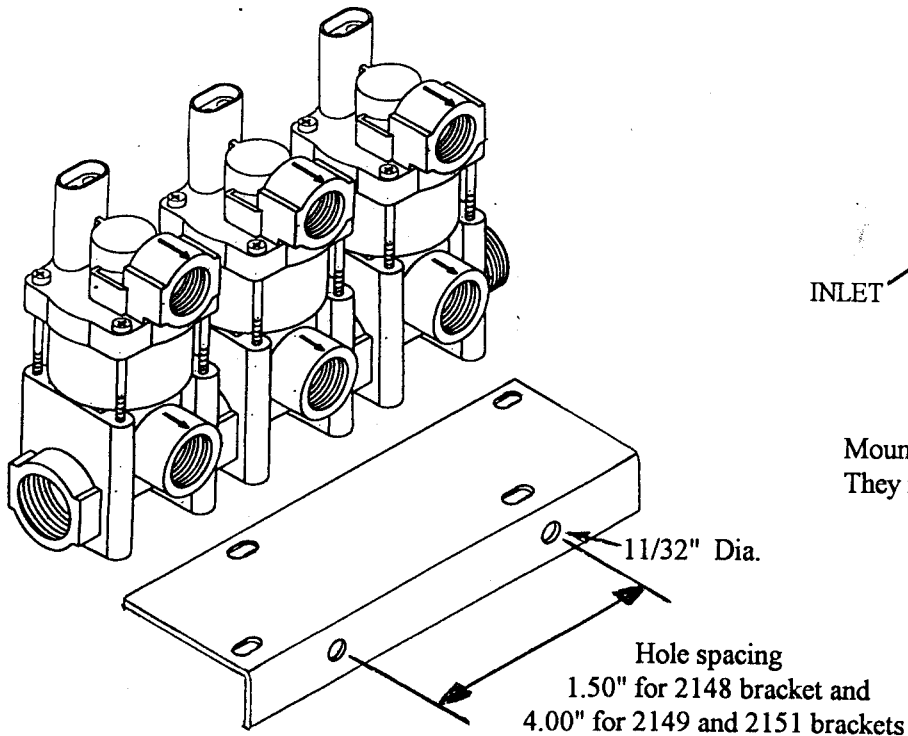
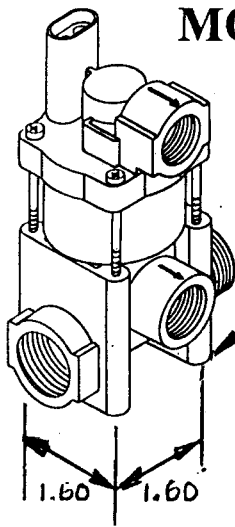

## INSTALLATION

It is advisable to install a strainer ahead of the valve. Note the arrows for flow direction.

The coil will radiate heat; therefore, it should not be enclosed.

After usage, always flush and drain valve.

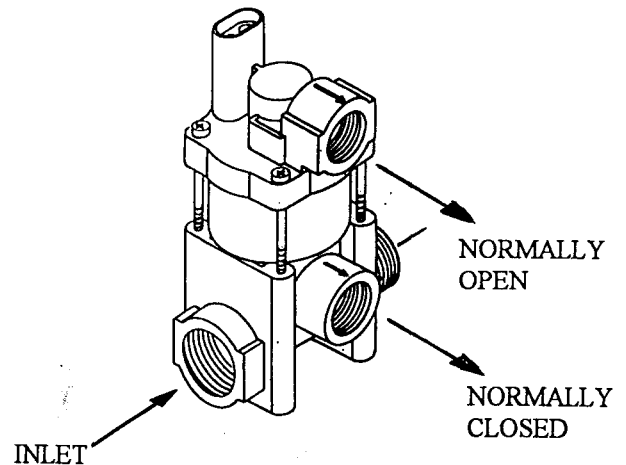

Mounting Brackets are not included with valves. They may be ordered from following as desired:

- 2148 Mounting Bracket for 2505-1
- 2149 Mounting Bracket for 2505-2
- 2151 Mounting Bracket for 2505-3

# MODEL 2505 3-WAY SOLENOID VALVE

2 GPM

80 PSI

12 VOLT

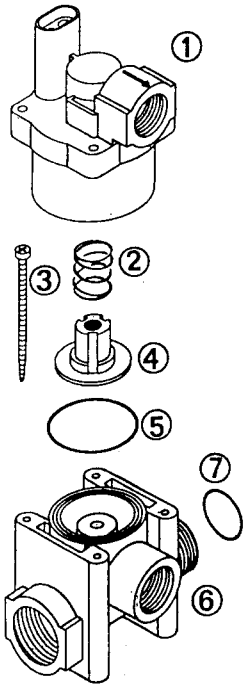

## PARTS LIST

Ref.	Part No.	Description	No. Req.
1	2499	Coil.....	1
2	2486	Spring.....	1
3		No. 8 x 2 1/2 Screw.....	4
4	2485	Plunger w/Viton Seat .....	1
5	2314	"O" Ring, .028 Viton.....	1
6	2498	Valve Body, .220 orifice.....	1
7	2166	"O" Ring, .018.....	1

## TROUBLE SHOOTING

Valve fails to open:

1. Check if the coil (1) is burned out.
2. Remove the coil (1) and check if the plunger (4) is stuck.
3. Check the control box and wiring harness for broken wires, bad switches and blown fuses.

Valve fails to shut-off:

1. Remove the coil (1) and check if the plunger (4) is stuck.
2. Check if the spring (2) is broken.
3. Check for proper electrical connections.

## TROUBLE SHOOTING

It is not necessary to take the valve out of the line to service it. The valve can be disassembled by removing the four No. 8 x 2 1/2" screws (3).

## ASSEMBLY

Assemble the valve as shown in the illustration. Be sure the small seat on the disc valve (4) is in the up position. Do not over tighten the No. 8 x 2 1/2" screws.

**TEXAS INDUSTRIAL REMCOR, INC.**

BOX 3704

TEMPLE, TEXAS 76505

(254) 982-4236